

SIDE VIEW

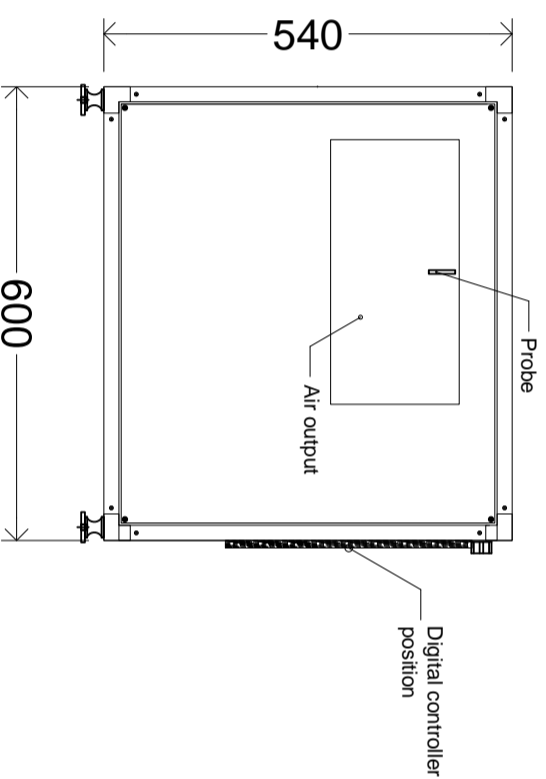

FRONT VIEW

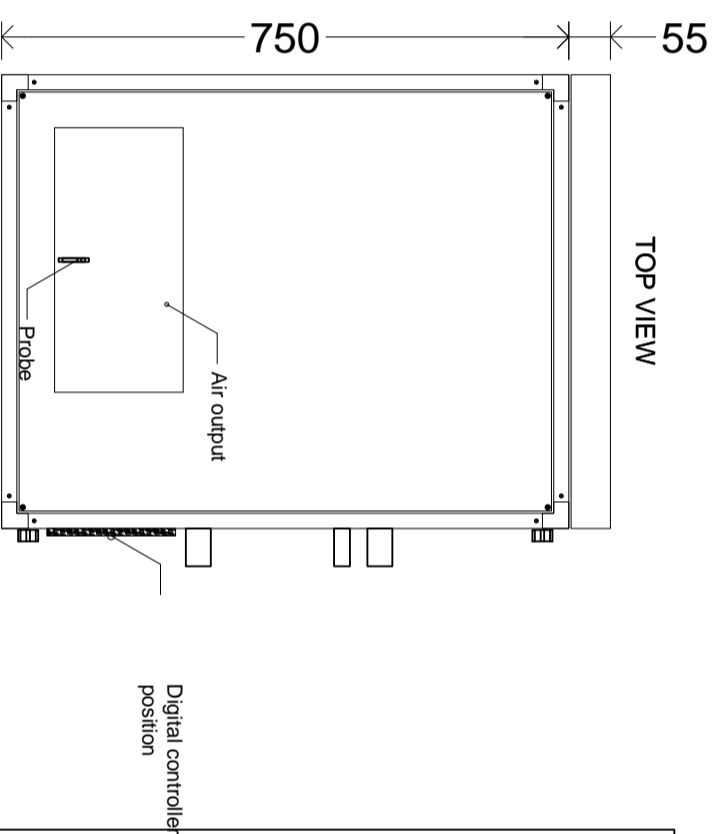

TOP VIEW

Verniciatura di colore bianco RAL9010
Painted with white color RAL9010

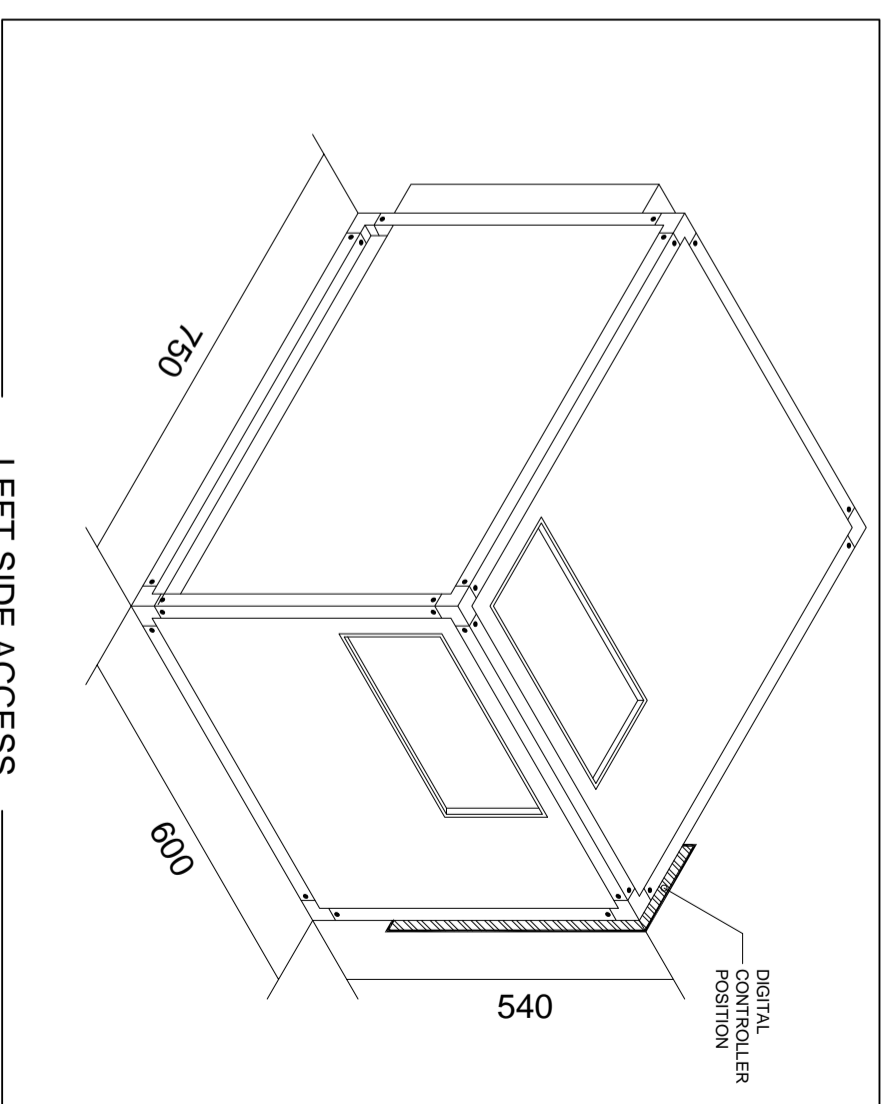

LEFT SIDE ACCESS

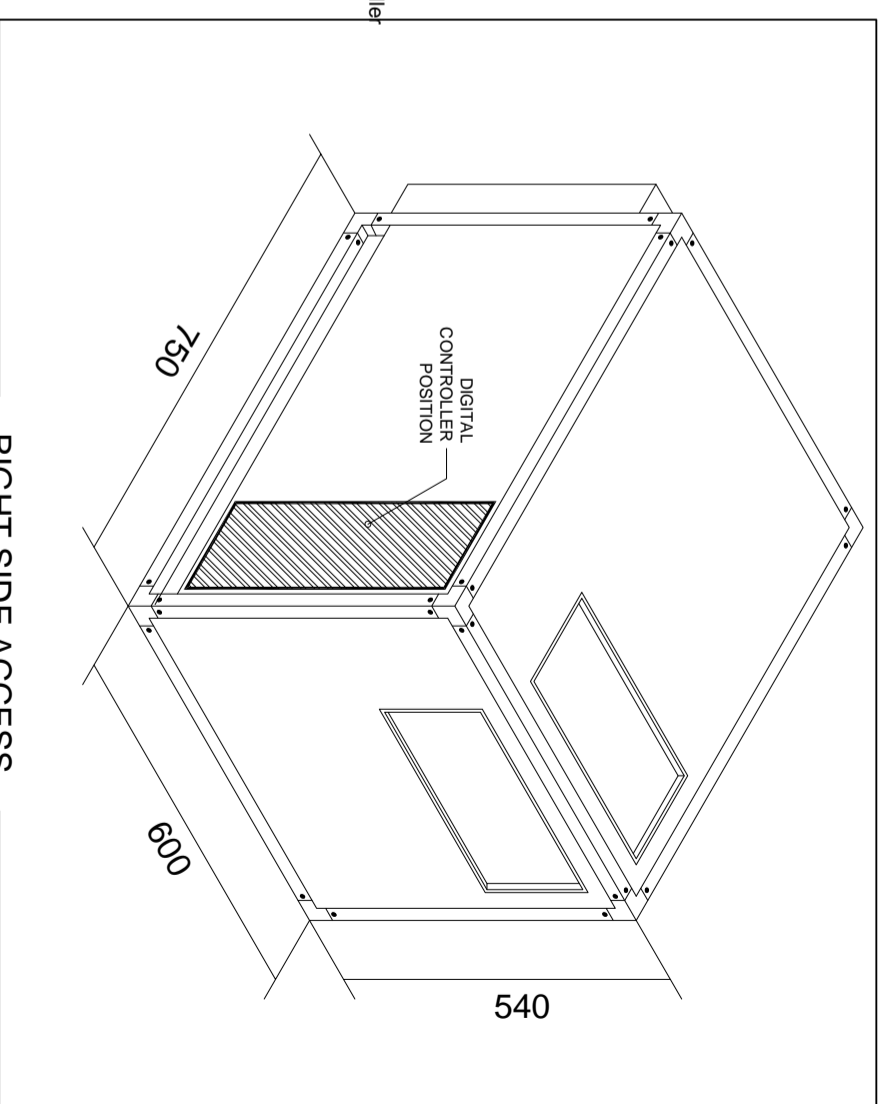

RIGHT SIDE ACCESS

- IMPORTANTE:**
- Il pannello di controllo deve essere sempre accessibile
 - Lasciare almeno 600mm di fronte al pannello strumenti per permettere l'estrazione della lampada UVC
 - Lasciare almeno 300mm di spazio di fronte all'uscita aria prescelta per poter posizionare il convogliatore di raccordo con le condotte aria
 - Verificare la possibilità di poter smontare il filtro per la pulizia periodica

- IMPORTANT:**
- The control panel must be always accessible
 - It's necessary to leave at least 600mm free space in front of the control panel to be able to remove the UVC lamp
 - It's necessary to leave at least 300mm free space in front of the air output to be able to install the air output plenum
 - It's necessary to check the possibility to remove the air filter

- CARATTERISTICHE:**
- Pannello comandi sul lato sinistro oppure destro (guardando il filtro aria)
 - Conessioni acqua trattata (IN/OUT): 3/4" F
 - Connessione scarico condensa (LEFT/RIGHT): 1/2" F
 - Alimentazione: 230V/1/50Hz
 - Assorbimento: 0.51kW
 - Assorbimento (lampada UVC): 0.05kW
 - Connessione elettrica (potenza): 2x +gnd
 - Connessione elettrica (comandi): 2x schermato (+ / gnd / -) (BELDEN 9841)
 - Massa (a vuoto): 54kg

- CHARACTERISTIC:**
- Connection panel on left or right side (looking into the air filter)
 - Treated water connection (IN/OUT): 3/4" F
 - Double drain discharge connection (LEFT/RIGHT): 1/2" F
 - Power supply: 230V/1/50Hz
 - Electric consumption: 0.51kW
 - Electric consumption (UVC lamp): 0.05kW
 - Electric connection (power): 2x +gnd
 - Electric connection (drive): 2x shielded (+ / gnd / -) (BELDEN 9841)
 - Net weight: 54kg



FRIGOMAR S.r.l.

Via V. Veneto, 112
16042 - Carasco (GE) ITALY
Ph. +39 185 384888 (788)

www.frigomar.com - frigomar@frigomar.com

REV. 2 -

REV. 1 -

DISEGNO N.°
F16110

DATA 13/07/2016

REAR VIEW

REV. 4

REV. 3 -

FRIGOMAR S.r.l.
Standard - UTA 1.500

Dis.: Alberto Puzzo

RIGHT SIDE ACCESS

FORMATO: A3

SCALA: 1:10

TAVOLA: 1/1

Tol. Gen.: ±2

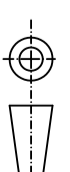



FRIGOMAR
EXCLUSIVE MARINE REFRIGERATION



FRIGOMAR F.M.U. (UTA1500)

Technical data

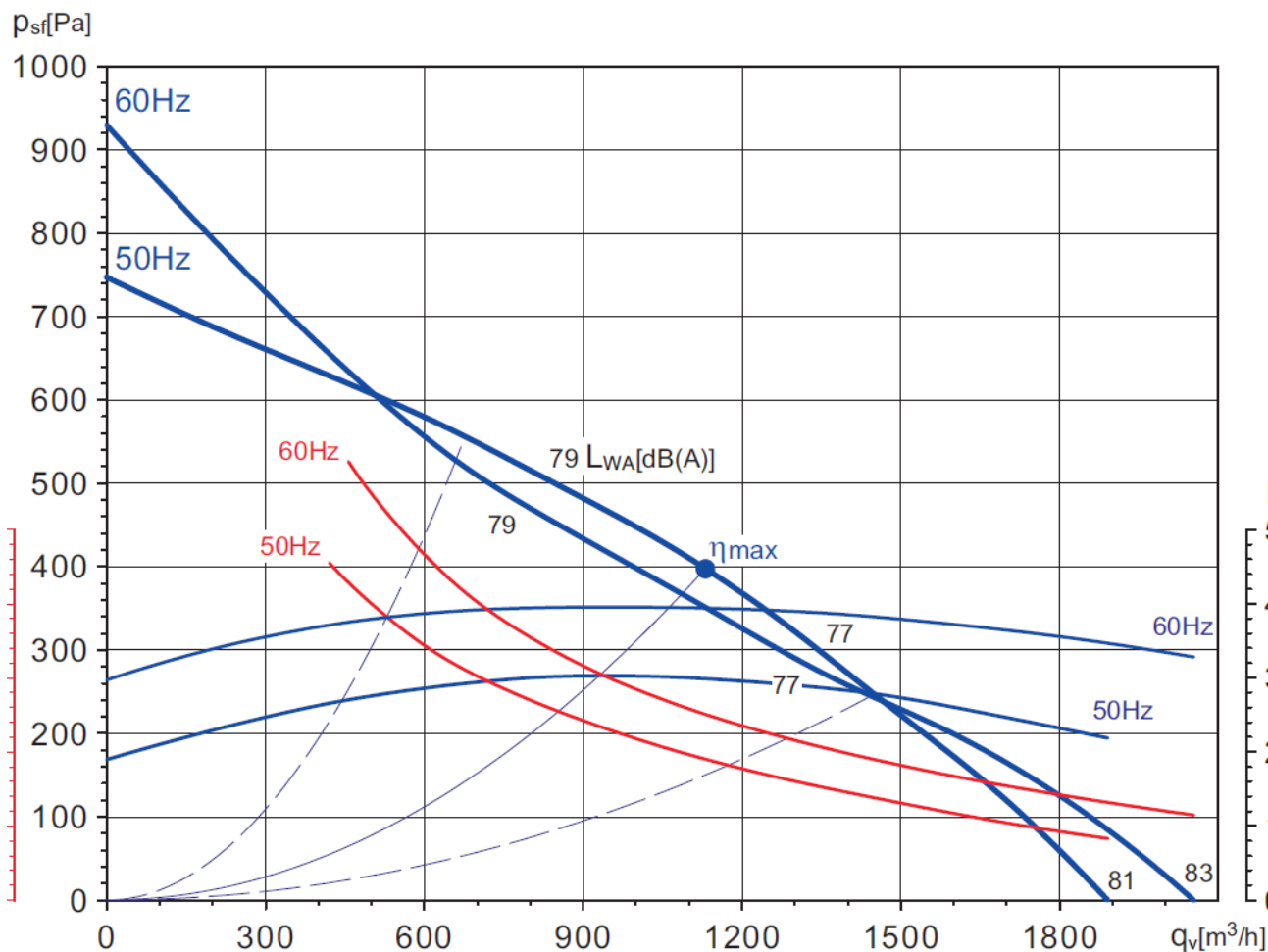

Air flow (m ³ /h)	Speed max (Pa)	Sound Power dB(A)
800	520	---
1000	450	---
1200	380	---
1400	280	---

Power supply	230V/1/50(60)Hz
Input power (max)	300W (400W)
Current drawn (max)	1.3A (1,7A)
Max ambient temperature	50°C (40°C)
Speed (max)	2700rpm (3000rpm)
Weight	12kg